



USERS MANUAL / GEBRUIKERSHANDLEIDING
BETRIEBSANLEITUNG / MANUEL D'UTILISATION
MANUAL DE UTILIZACION / INSTRUZIONI PER L'USO

MasterView Easy MkII

Monitoring and control panel for the MasterBus network



MASTERVOLT
Snijdersbergweg 93,
1105 AN Amsterdam
The Netherlands
Tel.: +31-20-3422100
Fax.: +31-20-6971006
www.mastervolt.com



ENGLISH:	PAGE 1
NEDERLANDS:	PAGINA 25
DEUTSCH:	SEITE 49
FRANÇAIS:	PAGINA 73
CASTELLANO:	PÁGINA 97
ITALIANO:	PAGINA 121

v 1.5 September 2010

CONTENTS:

v 1.5 September 2010

1	GENERAL INFORMATION.....	4
1.1	Product description	4
1.2	Use of this manual	4
1.3	Guarantee specifications	4
1.4	Liability	4
1.5	Identification label	4
2	SAFETY.....	5
2.1	Use of symbols	5
2.2	Use for intended purpose	5
2.3	Safety regulations and measures	5
3	MASTERBUS.....	6
3.1	What is MasterBus?.....	6
3.2	Event based commands	6
3.3	How to set up a MasterBus network.....	7
4	INSTALLATION	8
4.1	Flush mounting and panel mounting	8
4.2	Things you need	8
4.3	Installation step by step	8
5	OPERATION.....	9
5.1	General	9
5.2	Button control.....	9
5.2.1	Switching on and off.....	9
5.2.2	Locking.....	9
5.3	Navigation.....	9
5.4	Control	10
5.5	Maintenance	11
6	MONITORING AND CONFIGURATION.....	12
6.1	Monitoring	12
6.2	Masterview Easy configuration	13
6.2.1	Changing of characters	13
6.3	Masterview Easy Events.....	14
6.4	Event data.....	14
6.5	Follow the toggle leader	14
6.6	Favourite + control page.....	14
6.6.1	Name Favourites page.....	15
6.6.2	Areas	15
6.6.3	Devices.....	15
6.6.4	Groups.....	15
6.6.5	Items.....	15
6.6.6	Add	15
6.6.7	Example	15
6.6.8	Showing the Favourites page.....	16
6.7	Configuring other devices	16
6.8	Digital switches	16
6.8	Digital switches	16
6.9	Tanklevel Interface	17
7	ADDITIONAL INFORMATION.....	18

7.1	MasterAdjust software	18
7.2	Ordering information	18
8	TROUBLE SHOOTING	19
9	SPECIFICATIONS	21
9.1	Technical specifications	21
9.2	Dimensions	22
10	EC DECLARATION OF CONFORMITY	23

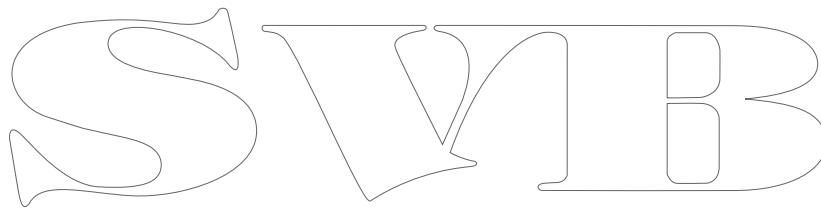

1 GENERAL INFORMATION

1.1 PRODUCT DESCRIPTION

The Mastervolt *MasterView Easy MkII* is a panel to monitor, configure and operate all connected devices in the MasterBus network.

1.2 USE OF THIS MANUAL

This manual serves as a guideline for the safe and effective operation, maintenance and possible correction of minor malfunctions of the *MasterView Easy MkII*, part number 77010305, called MasterView Easy from this section on.

Keep this manual at a secure place!

The English version has 24 pages.

1.3 GUARANTEE SPECIFICATIONS

Mastervolt guarantees that this product was built according to the legally applicable standards and stipulations. If you fail to act in accordance with the regulations, instructions and stipulations in this user's manual, damage can occur and/or the product will not fulfil the specifications. This may mean that the guarantee will become null and void.

1.4 LIABILITY

Mastervolt can accept no liability for:

- consequential damage due to use of the MasterView Easy;
- possible errors in the manuals and the results thereof.
- use that is inconsistent with the purpose of the product

1.5 IDENTIFICATION LABEL

The identification label (see figure 1) is located at the back side of the MasterView Easy. Important technical information required for service, maintenance & secondary delivery of parts can be derived from the identification label.

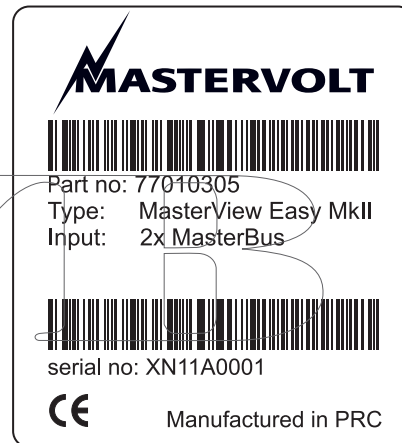

Figure 1:
Identification
label

Never remove the identification label!

2 SAFETY

2.1 USE OF SYMBOLS

Safety instructions and warnings are marked in this manual by the following pictogram:

**CAREFUL!**

Special data, restrictions and rules with regard to preventing damage.



A procedure, circumstance, etc which deserves extra attention.

2.2 USE FOR INTENDED PURPOSE

- 1 The *MasterView Easy* is constructed as per the applicable safety-technical guidelines.
- 2 Use the *MasterView Easy* only:
 - in a technical correct condition;
 - observing the instructions in the users manual.
 - connected to the MasterBus network
- 3 Use of the *MasterView Easy* other than mentioned in point 2 is not considered to be consistent with the intended purpose. Mastervolt is not liable for any damage resulting from the above.

2.3 SAFETY REGULATIONS AND MEASURES

Do not work on an electrical system if it is still connected to a current source. Only allow changes in your electrical system to be carried out by qualified electricians.

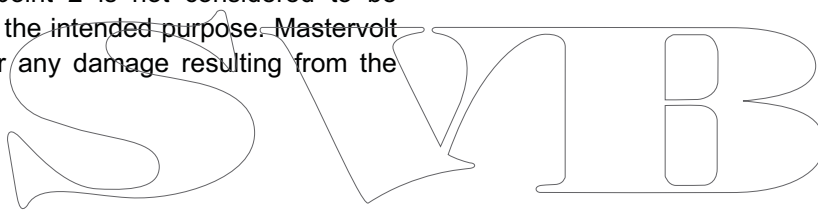

3 MASTERBUS

3.1 WHAT IS MASTERBUS?



All devices that are suitable for MasterBus are marked by the MasterBus symbol.

MasterBus is a fully decentralized data network for communication between the different Mastervolt system devices. The communication network is based on CAN-bus which has proven a reliable bus-system in automotive applications. MasterBus is used as power management system for all connected devices, such as the inverter, battery charger, generator and many more. This gives the possibility for communication between the connected devices, for instance to start the generator when the batteries are low.

MasterBus reduces complexity of electrical systems by using MasterBus cables. All system components are simply chained together. Therefore each device is equipped with two MasterBus data ports. When two or more devices are connected to each other through these data ports, they form a local data network, called the MasterBus. The results are a reduction of material costs as only a few electrical cables are needed and less installation time.

For central monitoring and control of the connected devices Mastervolt offers a wide range of panels which show full status information of your electrical system at a glance and a push of a button. Example is the full colour MasterView System panel. All monitoring panels can be used for monitoring,

control and configuration of all connected MasterBus equipment.

New devices can be added to the existing network in a very easy way by just extending the network. This gives the MasterBus network a high degree of flexibility for extended system configuration, not only today, but in the future as well!

Mastervolt also offers several interfaces, making even non-MasterBus devices suitable to operate in the MasterBus network.

For direct communication between the MasterBus network and a product which is not from Mastervolt, the Modbus interface is recommended.



CAUTION: Never connect a non-MasterBus device to the MasterBus network directly! This will void warranty of all MasterBus devices connected.

3.2 EVENT BASED COMMANDS

With MasterBus each device can be programmed to initiate an action at another connected device. This is done by means of *event based commands*.

Example: if the shore power is almost in overload, a generator must be started.

As the shore power is measured by the *Mass Systemswitch*, this device is considered as the *command source*. The generator is the device that should initiate an action (start the generator), and is therefore considered to be the *target*. This means that the *Mass Systemswitch* must be programmed as follows:

Event source:	Shore pre overload	Select from <i>list of events sources</i> (see manual of the <i>Mass Systemswitch</i>)
Event target:	Generator	Select from the <i>device list</i> (devices connected to the MasterBus)
Event command:	Status	Select event command from the <i>list of event commands</i> of the target (see manual of the <i>Generator</i>)
Event data:	On	Select event action from the <i>list of event commands</i> of the target (see manual of the <i>Generator</i>)

See chapter 6 for the MasterView easy *list of event sources* and *list of event commands*.

3.3 HOW TO SET UP A MASTERBUS NETWORK

Every device that is suitable for the MasterBus network is equipped with two data ports. When two or more devices are connected using these ports, together they form a local data network, called the MasterBus.

Keep the following rules in mind:

Connections between the devices are made by standard straight MasterBus cables. Mastervolt can supply these cables. These cables are also commonly available at computer supply stores.

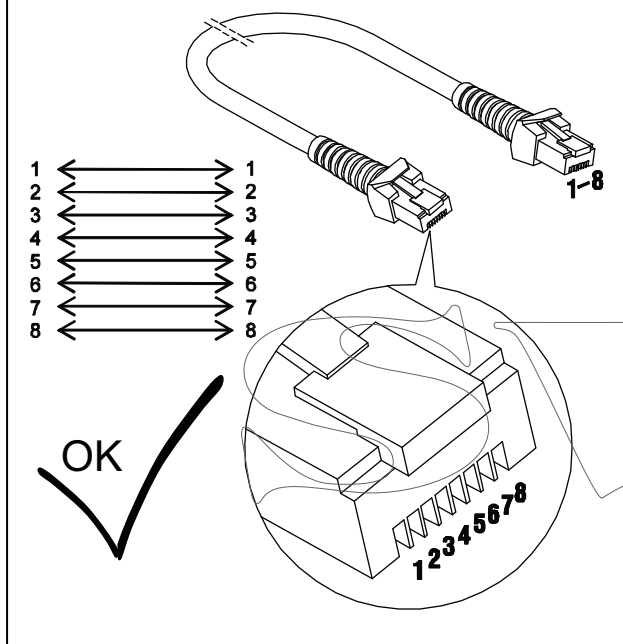

Figure 2

As with all high speed data networks, MasterBus needs a terminating device on both ends of the network .

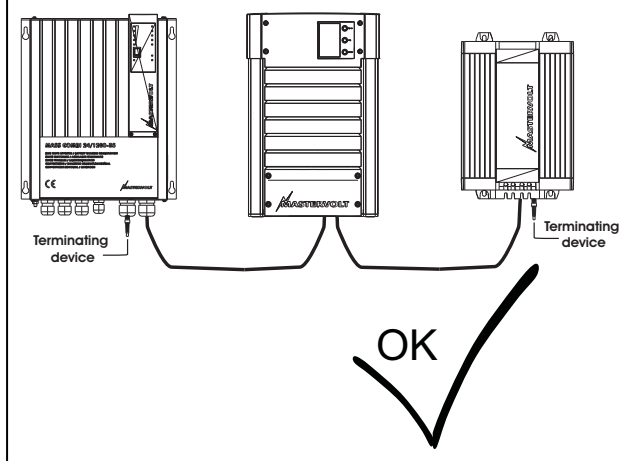

Figure 3

The electric power for the network comes from the connected devices.
 At least one device in the network should have powering capabilities (see specifications).
 One powering device can power up to three non-powering devices.
 As all powering devices are galvanically isolated, multiple powering devices are allowed.

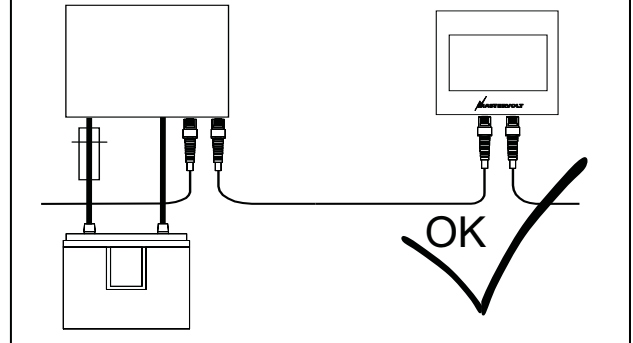

Figure 4

Do not make ring networks.

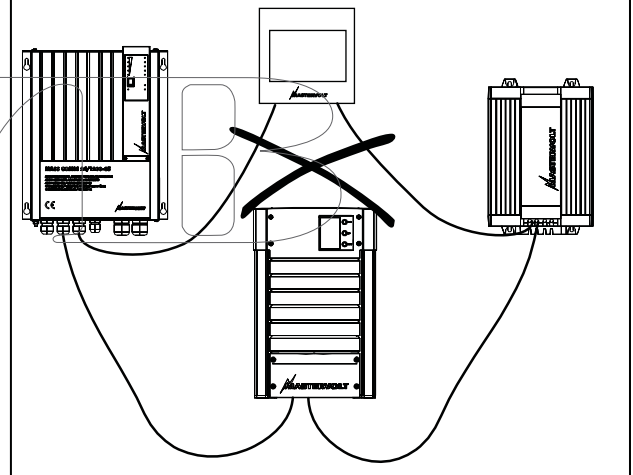

Figure 5

Do not make T-connections in the network.

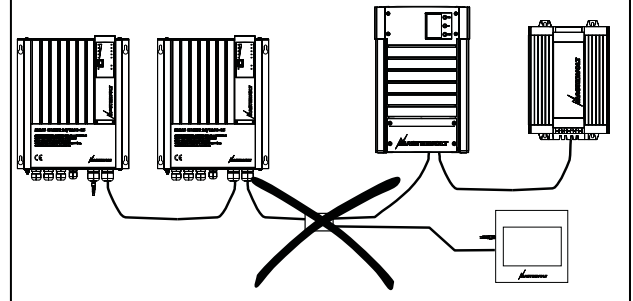

Figure 6

4 INSTALLATION



WARNING

During installation and commissioning of the *Masterview Easy*, the Safety Guidelines and Measures are applicable at all times. See chapter 2 of this manual.

4.1 FLUSH MOUNTING AND PANEL MOUNTING

The Masterview Easy can be flush mounted or panel mounted on a wall or board. For flush mounting the outer housing can be removed easily. The connections are at the back of the panel and space for the two MasterBus connectors is provided when for panel mounting is opted.

4.2 THINGS YOU NEED

Tools:

- A drill for the mounting holes
- A saw to make a cut-out for flush mounting the panel
- A cross-head screw driver

Materials:

- The *MasterView Easy* panel (included)
- 4 screws for mounting (included)
- MasterBus connection cable (MasterBus cable) (6 meter / 20ft included)
- MasterBus terminating devices (1 pc included)

4.3 INSTALLATION STEP BY STEP

1

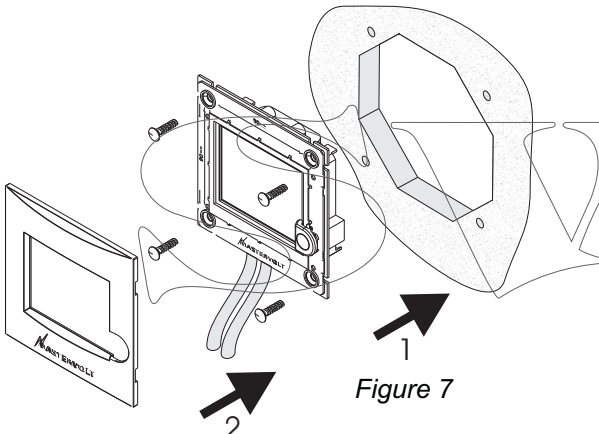

Figure 7

Flush mounting the MasterView Display.

- Remove the outer housing and remove the front from the panel.
- Make a cut out in the mounting wall and drill the holes using the saw template in the box or using the dimensions on the panel.
- Insert the MasterBus connection cables into the MasterBus data ports.
- Mount the MasterView Easy onto the panel (1) and then reattach the front (2), see figure 7.

2

Panel mounting the MasterView Easy Display

- Remove the outer housing and remove the front.
- Drill the holes using the dimensions inside the outer housing and fasten the outer housing (1).
- Insert the MasterBus connection cables into the MasterBus data ports and click the panel into the outer housing (2).
- Reattach the front (3), see figure 8.

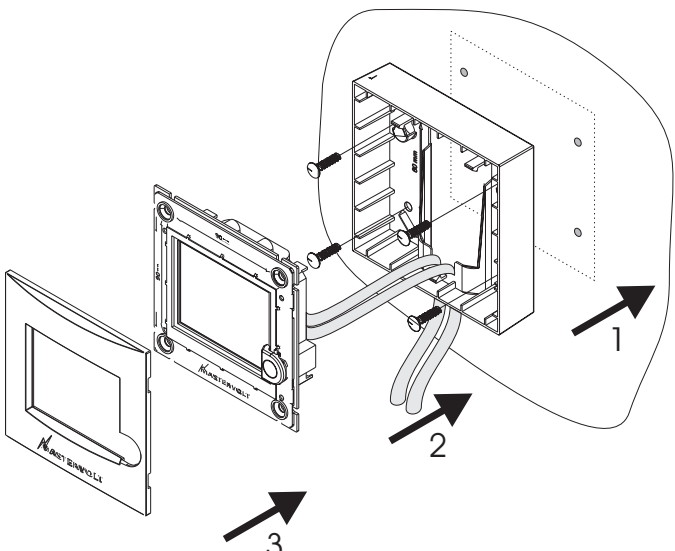

Figure 8

5 OPERATION

5.1 GENERAL

The Mastervolt *MasterView Easy* is a central monitoring and control panel for devices that are connected to the MasterBus network. It shows status information of your electrical system by means of a touch screen.

5.2 BUTTON CONTROL

5.2.1 Switching on and off

Press the button shortly to switch on the *MasterView Easy panel*. See figure 10. After a short time the first screen is shown, for device selection. Pressing the button shortly again results in switching off the Easy panel.

5.2.2 Locking

Pressing the button for more than two seconds when the Easy panel is switched on, results in locking the panel, see figure 10. In this mode the panel will not react on pressing the screen. The “locked” key is shown in the left lower corner, see figure 10.

Unlocking is accomplished by pressing the button for more than two seconds again.



NOTE: As every configuration of the MasterBus network is unique, this user's manual can not give specific instructions for any particular device connected, except for the *MasterView Easy* itself. Refer to the user's manual of the connected device for an overview of all available readouts and settings.

5.3 NAVIGATION

Monitoring and control of the *MasterView Easy* can be done by scrolling through the menus.

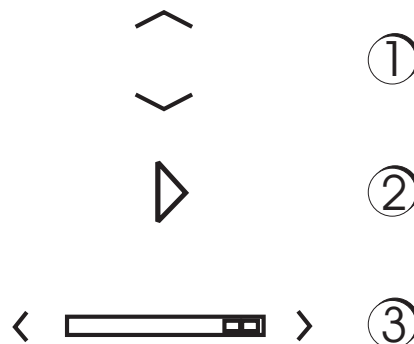

Figure 9 navigation buttons

- Press the Up and Down arrow to scroll through a menu vertically (see figure 9, number 1)
- Press the Up and Down arrow to increase resp. decrease a value or (see figure 9, number 1)
- Press the closed arrow to show a group (see figure 9, number 2)
- Press the Right or Left arrow to scroll through a menu horizontally, through the groups (see figure 9, number 3)
- Press X to leave a menu or to cancel a setting (see figure 11). You will then return to the main menu.

5.4 CONTROL

The **MasterView Easy** is a monitoring and control panel for the MasterBus network. The display guides you through the different menus, starting with the selection of device you wish to monitor. See the example on these two pages.

NOTE: The screens shown may differ from the screens on your own MasterView Easy.

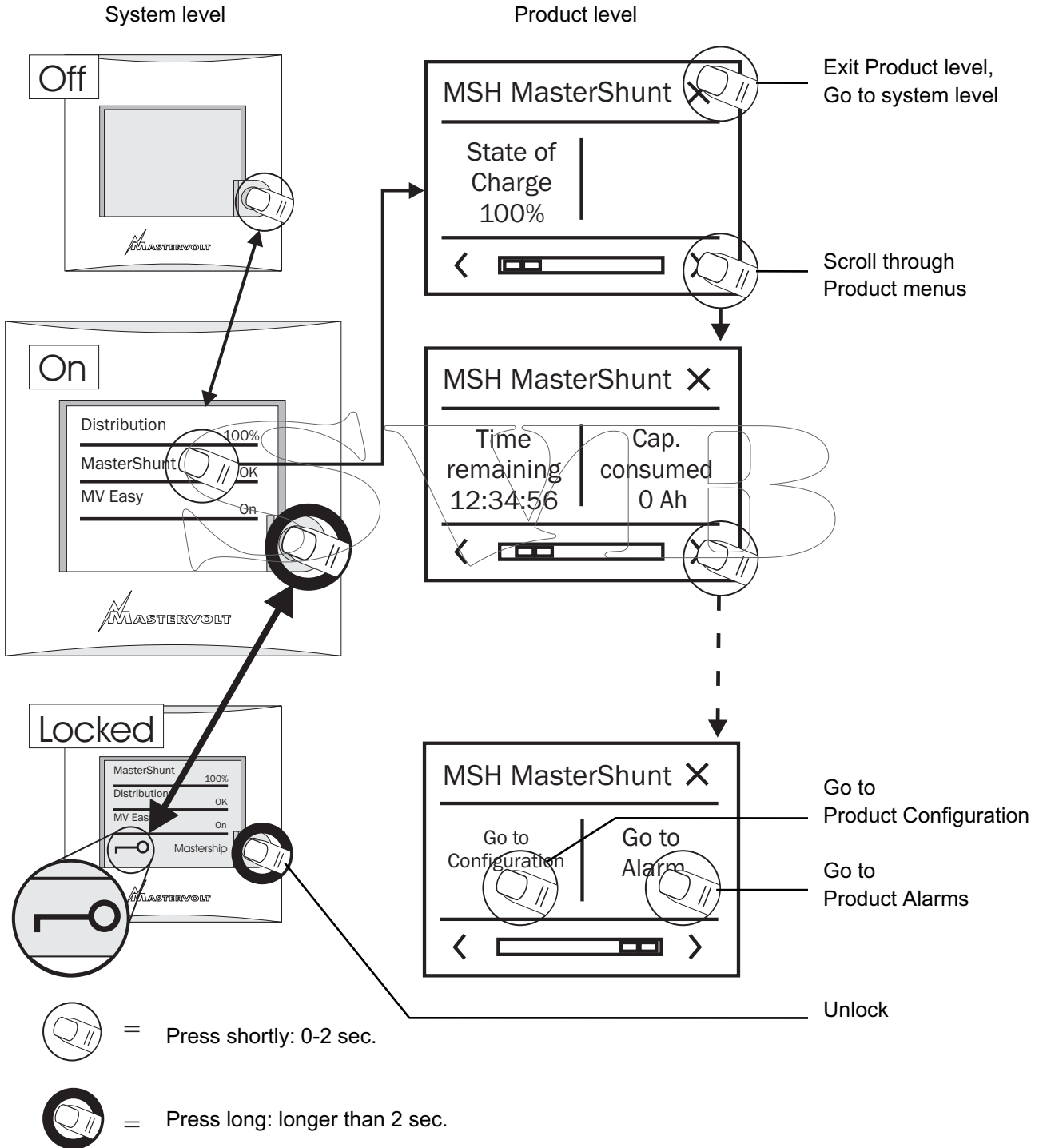

Figure 10: Operation of the MasterView Easy, opening screens

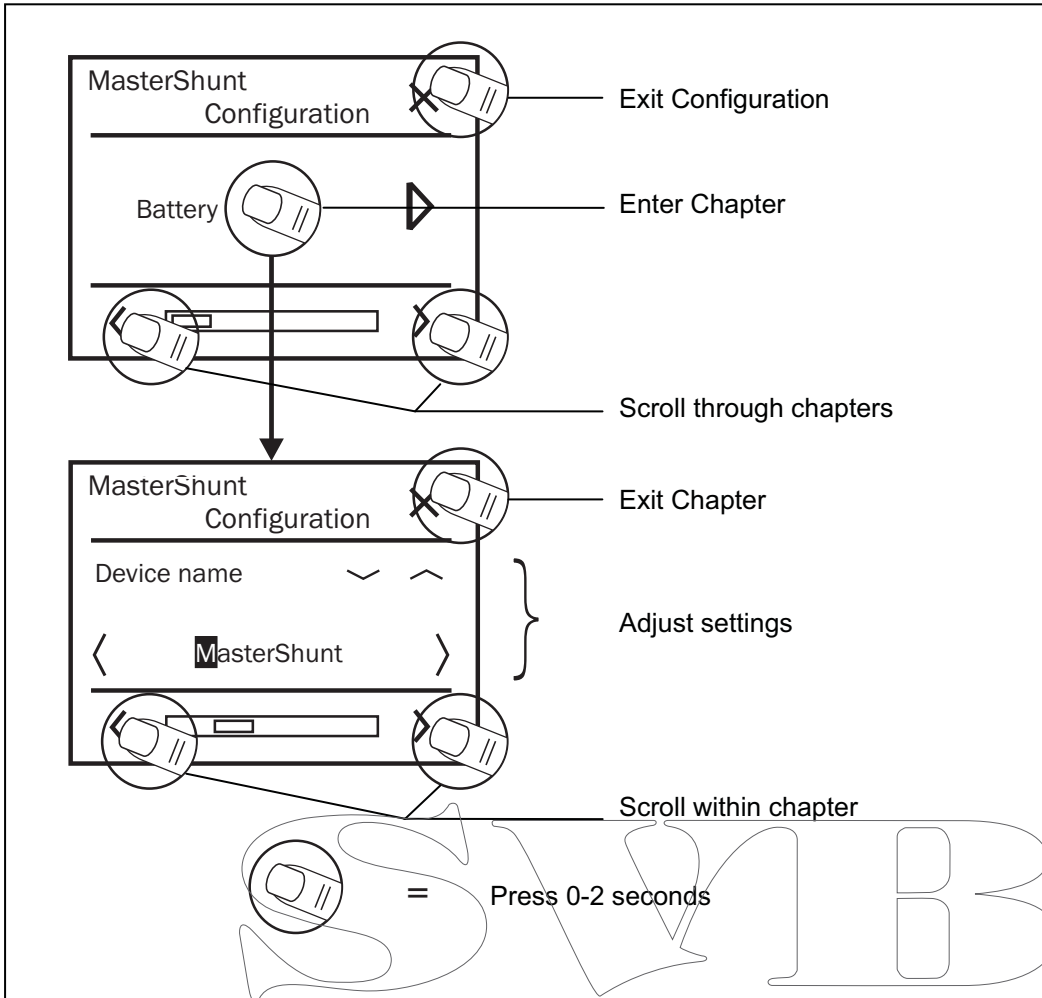

Figure 11: Operation of the MasterView Easy, example Configuration

5.5 MAINTENANCE

If you need to clean the touch screen without controlling function, use Keyboard Lock. Press button long to lock keyboard, see figure 10.

Clean touch screen with a soft cloth. Do NOT use acids or scourers!
Press button long again to unlock keyboard.

6 MONITORING AND CONFIGURATION

6.1 MONITORING

The MasterView Easy start screen shows the Device List, see also figure 10. By selecting the Easy display itself, you will enter the *MasterView Easy*

monitoring menu, see the table below.

The settings are stored in the internal memory of the selected device. As a result of this, switching off the *MasterView Easy* will not influence the settings.

Variable	Meaning	Default	Range
Language	Displayed language of the <i>MasterView Easy</i> . This display enables changing the language of all connected MasterBus devices in one go.	English	See specifications
Backlight	Illumination of the display's backlight.	Auto	Auto/On/Off
Switch X	Configurable switch on the MasterView Easy	-	X = 1 to 6
Go to configuration	Press <i>Enter</i> to continue with the configuration menu.		

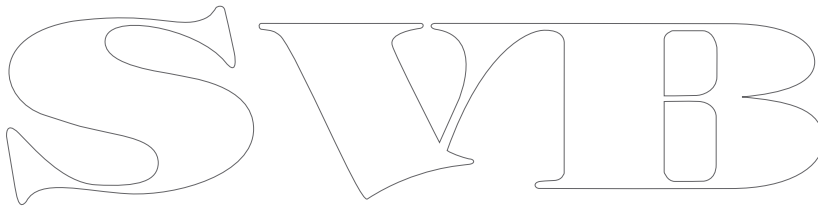

6.2 MASTERVIEW EASY CONFIGURATION

To change settings of the MasterView Easy display, press Go To Configuration. The MasterView Easy configuration menu is used for read out and adjustment of settings like backlight illumination, displayed language and number of devices.



The MasterView Easy Configuration Lock disables configuration of all connected devices. After selection of *Configuration Enabled* the Configuration Lock symbol disappears in all configuration groups. The first configuration group (at Easy panel: General) always remains enabled.

Variable	Meaning	Default	Adjustable. range
General			
Name yacht	Name of the boat, the panel is installed on. See also section 6.2.1.	Yacht name	Maximum 16 characters
Device name	Name of this device. This name will be recognized by all connected devices.	DIS MV Easy	DIS+Maximum 12 characters
Switch X	Switches to use for event configuration. Renaming the switches after their application is recommended. X ranges 1 – 6.	Switch X	Maximum 16 characters
Devices in list	Devices to show in the device list. At <i>Selection</i> three selection boxes appear to choose a MasterBus device connected. <i>Excluded</i> means, you can select all devices except maximum three devices.		Selection, All, Excluded
Buzzer	Switching of the buzzer. The buzzer can also be target in the MasterBus events, if activated it sounds for maximum 1 minute. See also section 6.3. This means the buzzer can sound even if you switched it off in the configuration.	On	On, Off
Auto Lock after	Time after which to lock the panel.	Off	Off, 2, 5, 10 minutes
Backlight	Choose the backlight colour. In alarm the backlight turns red, if not red already.	White	White, Red
Power save			
Backlight time	Time the display backlight stays illuminated since the last button was touched.	2 minutes	always off, 2 minutes, 5 minutes, 10 minutes, always on
Auto off	Time after which the <i>MasterView Easy</i> will be switched off since the last button touch.	1 day	1 day, 2 days, always on
Backlight	Percentage of illuminance	50%	0-100%, in 10% steps
Favourites page			
Name fav. page	Name of your Favourites page.	-	Maximum 16 characters
Favourites page	Selection of areas to show. <i>Analogue</i> means, a bar is shown instead of a value.	no	No, analogue, 1,2,3,4,6 areas, 1-3 tanklevels
Connect to Fav			
Connect to	Area to connect the next item to	Area 1	Area 1,2,3,4,5,6
Device	Device to add the monitoring item from	Select...	System dependent
Group no.	Group number in monitoring page selected	1	1-65535
Item no.	Item number in monitoring page selected	1	1-65535
Add	Add the item to the Favourites page		

In *Connected favour.*, a list of the added monitoring items for the chosen areas is shown. This list is read only in user level.

6.2.1 Changing of characters

Changing of characters, for instance the yacht name, is accelerated by keeping the up/down arrow

pressed. The characters change then in *second gear*.

6.3 MASTERVIEW EASY EVENTS

Shown are the events to configure on the MasterView Easy.
For instance a light can be switched Off when the

Easy is switched On, the event source is then State
These event sources can be used to initiate an event command and an event *action by an other device* that is connected to the MasterBus.

Variable	Meaning	Default	Adjustable. range
Event X Source	Choose an event to serve as Event X Disabled means no event has been configured. The MasterView Easy features 6 Switches to serve as event sources. These switches can be named after their application.	Disabled	Disabled, Switch 1 - 6, Backlight change, State
Event X Target	Selection of the MasterBus connected device to take action due to Event X	Choose...	System dependent
Event X Command	<i>Event-based command</i> Action to be taken by the Event X target.	Choose...	System dependent
Event X Data	Event 1 data controls the Event X command, see section 6.4 for explanation.	Off	Off, On, Copy, Copy Invert, Toggle

6.4 EVENT DATA

Figure 12 shows an example of Input (pulses) and Output (data) to explain the Event Data.

On changes the status to On at the first signal.
Off changes the status to Off at the first signal.
Copy lets the status follow the input.
Copy Invert lets the status follow the opposite of the input. Copy is used for dimming too by holding the pulse switch pressed for a longer time.
Toggle changes the status at the first signal and back at the second signal. It is used in combination with a pulse switch.

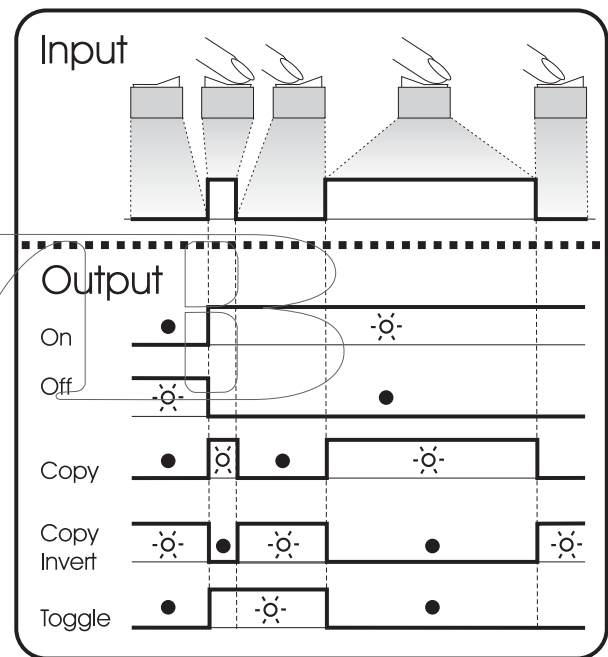

Figure 12: Event Data

6.5 FOLLOW THE TOGGLE LEADER

If two or more targets of the MasterView Easy MkII are configured for one toggle switch, the first event for this switch is the *leading* toggle event. The other events are the *following* toggle events. They borrow their state from the leading event.

Example: Event 4 is the leading event. The states of event 4,5,6 are 0,1,1 respectively. Operating the toggle switch results in state 1 for event 4 (toggled from 0). Event 5 and 6 borrow state 1 from event 4, so the event states are now 1,1,1 respectively.

6.6 FAVOURITE + CONTROL PAGE

The MasterView Easy MkII Favourites page is designed to monitor the other connected MasterBus devices in one overview.

This page shows up to 6 monitoring items on one screen. An example of a monitoring item is the Battery State of Charge, measured by the MasterShunt. These items are selectable from the monitoring tabs of connected MasterBus devices.



For configuration, using the MasterAdjust or System Panel software is necessary to recognize the group and item numbers.

6.6.1 Name Favourites page

Enter the maximum 16 character name of your Favourites page.

6.6.2 Areas

Select the number of areas on your Favourites page. 1, 2, 3, 4 or 6 areas on the MasterView Easy are selectable to show your monitoring items. Besides that, 1, 2 or 3 tank levels can be displayed, see also section 6.9.

6.6.3 Devices

Up to 63 connected MasterBus devices are selectable to choose your monitoring items from.

6.6.4 Groups

The monitoring items are ordered in groups, for instance figure 13 shows one group with the name General. Choose the group, starting to count at 1.

6.6.5 Items

Choose the item in the monitoring group of the device concerned. Start to count at 1. So item 1 is the first item in that group. The item will be shown in the area you selected.

6.6.6 Add

Add puts the item into the area you selected. This is done by pressing the button Add.

6.6.7 Example

See figure 13. For instance you have a MasterShunt installed and you want the *Battery state of charge* to be shown in the first of the six areas on your MasterView Easy.

Go to Configuration in the Easy menu.

Select **Favourites page** and name this page.

Select **6 areas** and then touch *Connect to fav.*

Under **Connect to** select *Area 1*.

Under **Device** select your *MasterShunt*.

Select *Group no. 1* and *Item no. 1*.

Finally press **Add** and confirm.

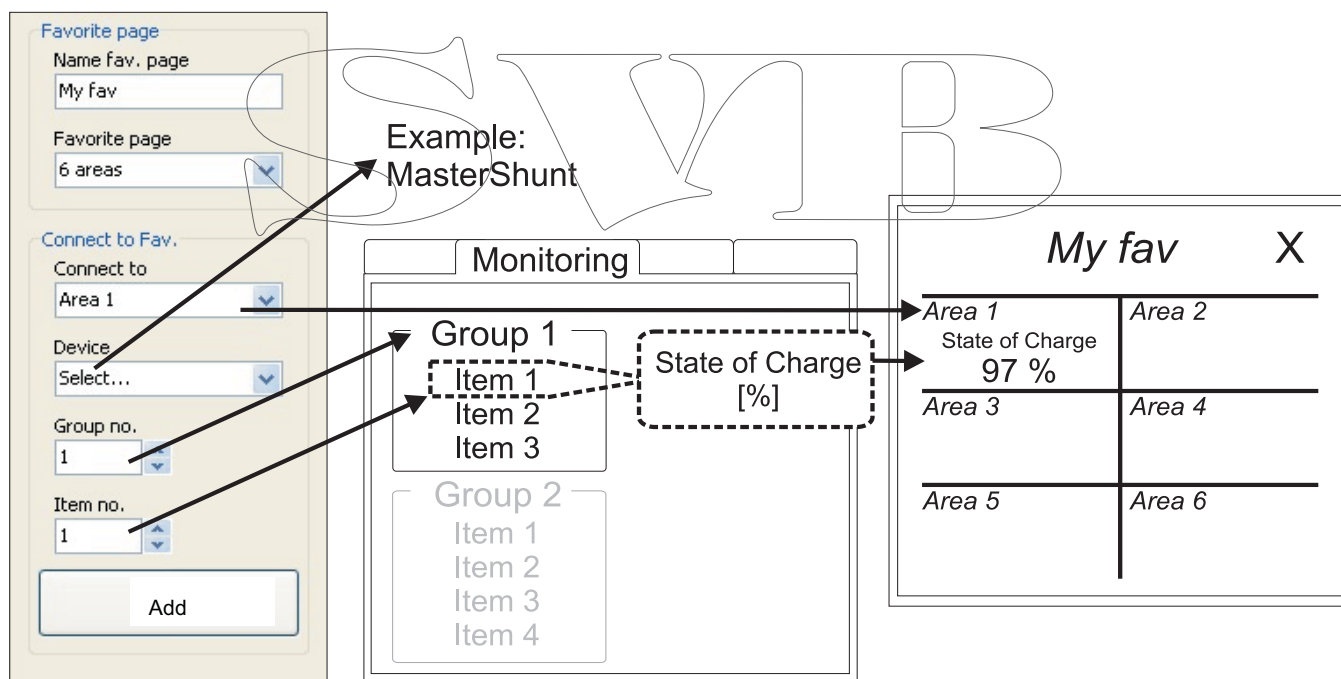

Figure 13: Configuration of Area 1

6.6.8 Showing the Favourites page

The Favourites page is accessed by pressing the button with the same name, see figure 14.

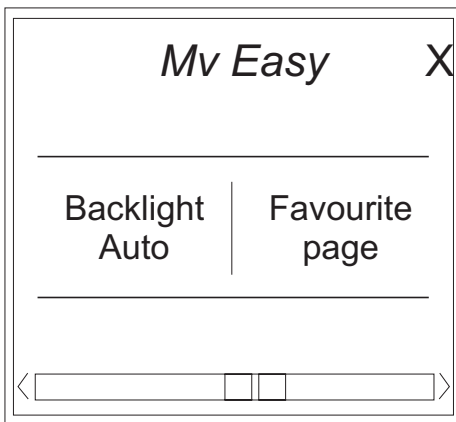

Figure 14: Favourites page button



NOTE: The Favourites page appears automatically after 20 seconds when the MasterView Easy panel is in the start up screen (device list). This only happens when you actually configured the Favourites page.

See figure 15. The item selected is being shown under *Connected favor.* The *Area 1 device* is the MSH MasterShunt. The 1 under *Area 1* is the *Index*. It shows the item you added is available and the connection with the device is present. You can check the index by selecting the menu of the according device and mouse over the item (in this example the MSH MasterShunt: group 1 is Monitoring and item 1 is the State of Charge).



NOTE: If you want to change the item to be displayed in an area, reconfiguring that area is possible.

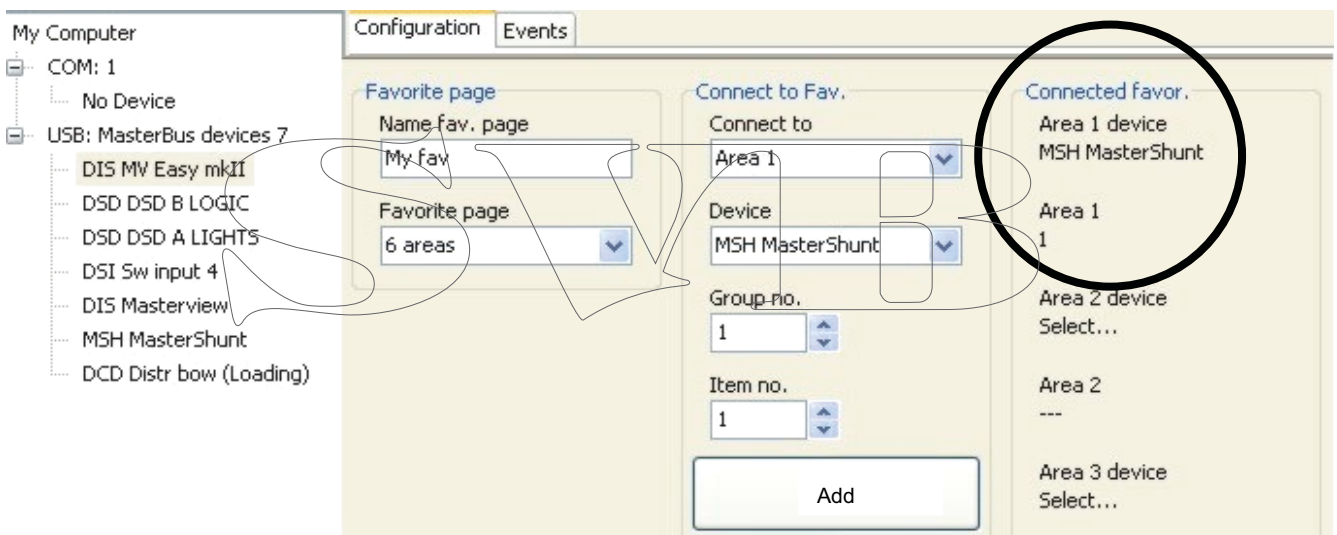

Figure 15: Favourites page configuration

6.7 CONFIGURING OTHER DEVICES

Monitoring and configuring other devices is possible by selecting a device in the MasterView Easy device list, see section 6.1. Refer to the user's manual of the connected device for an overview of all available settings. Settings are stored in the memory of the selected device. This means that switching off or disconnecting of the *MasterView Easy* will not affect the settings of the connected devices. See section 6.2 for the Configuration Lock of all connected devices.

6.8 DIGITAL SWITCHES

The MasterView Easy MkII features 6 digital switches to be used in the Favourites page. Their function is based on event configuration of mainly other devices. The switches, named Switch 1 to 6, can be renamed after their application, see figure 16. An example is Switch 1, named Kitchen. The switches are in the Easy Monitoring screen basically to add them to the *Favourites page*, see figure 13.



NOTE: To have a switch displayed at the Favourites page, you need to add it! Refer to section 6.6.7 for an example.

6.8.1 Switch configuration

To have a switch really control a channel on the Digital DC 10x10A, you need to perform the event configuration. Figure 17 shows how to let the switch called “Kitchen” control channel 6 of the Digital DC. Now, Kitchen on the Favourites page (see figure 19) toggle switches channel 6.

6.8.2 Feedback configuration

Only switches of the MasterView Easy itself can show feedback information on its Favourites page. See figure 18. For instance Kitchen is Event configured to toggle switch channel 6 of the Digital DC 10x10A. The Digital DC can be Event configured to send a *feedback* signal to Kitchen if it is really switched On. The “LED” in Kitchen then turns black, see figure 19. In case of alarm, it blinks.

 **NOTE:** Only the MasterView Easy MkII switches can be configured for the Easy MkII feedback function!

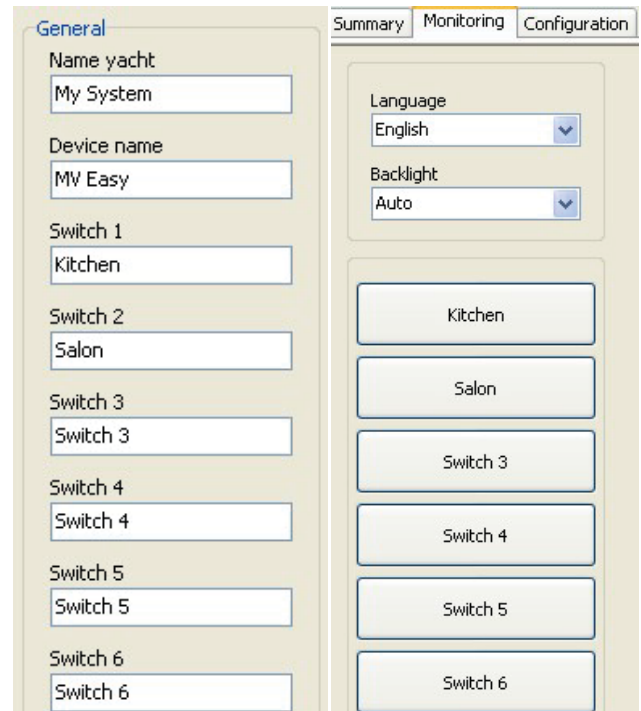

Figure 16: Configuration, monitoring of switch 1-6

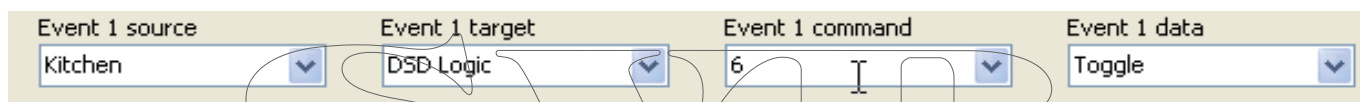

Figure 17: Switch configuration at the MasterView Easy MkII



Figure 18: Feedback configuration at the Digital DC 10x10A

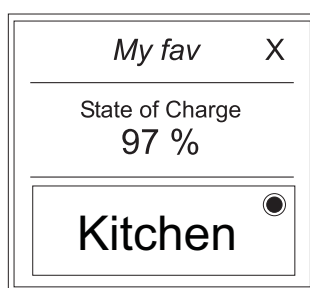

Figure 19: Favourites page with switch. The circle in the switch functions like a feedback

6.9 TANKLEVEL INTERFACE

The MasterView Easy MkII features three Favourites page display options for the Tanklevel Interface, see figure 20. Select 3 tank levels and after that, add the group and item to the areas (see section 6.6.8).

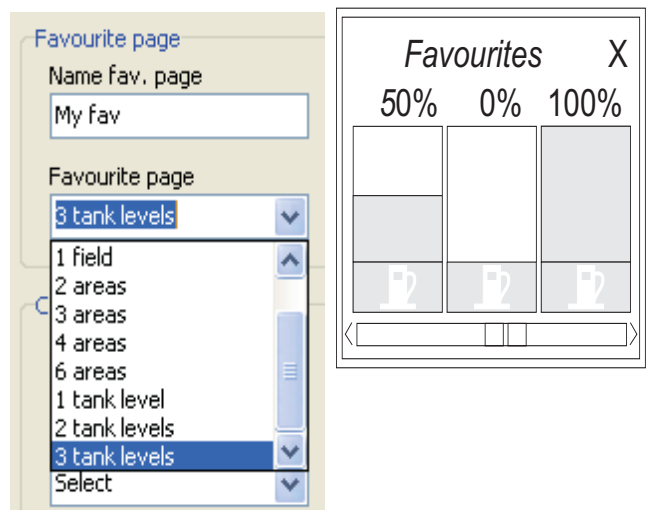

Figure 20: Tank levels configuration and displays

7 ADDITIONAL INFORMATION

7.1 MASTERADJUST SOFTWARE

For Favourites page settings you need the MasterAdjust or System Panel software. To use MasterAdjust, you need a MasterBus-USB interface for communication between your PC and the MasterBus. See ordering information. See the user manual of the MasterBus-USB interface for detailed information.

Mastervolt MasterAdjust software is available as free to download software on the Mastervolt website (www.mastervolt.com). Features:

- System configuration: to adjust the entire MasterBus network and all connected devices in accordance with your personal preferences, including programming of *Event-based commands* (see section 6.4);
- System Monitor: complete actual overview of your entire electrical installation;

- System logger: data logging instrument to retrieve historical data of your electrical installation.

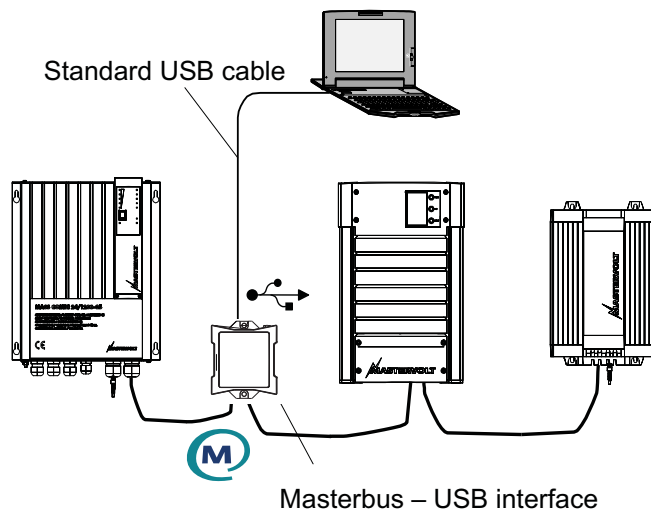

Figure 21: MasterBus-USB interface

7.2 ORDERING INFORMATION

Part number	Description
77040000	MasterBus terminating device*
77040020	MasterBus cable, 0,2m
77040050	MasterBus cable, 0,5m
77040100	MasterBus cable, 1,0m
77040300	MasterBus cable, 3,0m
77040600	MasterBus cable, 6,0m*
77041000	MasterBus cable, 10m
77041500	MasterBus cable, 15m
77042500	MasterBus cable, 25m
77050100	100m / 330ft MasterBus cable (UTP cable)
77050200	50 pcs. modular jacks
77050000	Complete set to assemble MasterBus cables. Delivery includes: 100 meter UTP cable, 50 pcs. modular jacks and crimping tool
77030100	MasterBus-USB interface, required as interface between your PC and the MasterBus when using MasterAdjust software.

* These parts are standard included with the delivery of the *MasterView Easy*

Mastervolt can offer a wide range of products for your electrical installation, including an extended program of components for your MasterBus network. Our website www.mastervolt.com shows an overview of all our products and free downloadable software.

8 TROUBLE SHOOTING

Contact your local Mastervolt Service Centre if you cannot correct a problem with the aid of the

malfunction table below. See www.mastervolt.com for an extended list of Mastervolt Service Centres.

Failure	Possible cause	What to do
No display function.	Display is switched off.	Press button.
	Error in the wiring.	Check the MasterBus cables.
	No powering device available on the MasterBus.	The <i>MasterView Easy</i> must be powered by the network. This means that at least one device in the network should have powering capabilities (see section 3.3).
Display shows ALARM.	A MasterBus device connected indicates an alarm situation.	Check the alarm source shown on the display and press STOP to stop the alarm or SNOOZE to let the alarm repeat every 9 minutes.
Backlight suddenly changes colour from white to red.	An alarm situation triggers the backlight to turn red. See also section 6.2.	Check the alarm source shown on the display and press STOP to stop the alarm or SNOOZE to let the alarm repeat every 9 minutes.
Back light does not switch on after touching the screen.	Back light has been set to switch off.	Check MasterView Configuration. See section 6.1, 6.2.
Back light does not switch off.	Back light settings wrong.	Back light settings need to be changed. Check MasterView Configuration. See section 6.1, 6.2.
No backlight.	Backlight switches off after default 2 minutes.	Press one of the buttons or refer to section 6.2 to adjust the settings of the backlight.
Slow or no communication.	Error in the MasterBus wiring.	Check the MasterBus cables.
	No terminating device placed at the ends of the network.	MasterBus needs a terminating device on both ends of the network. Check if connected (see section 3.3).
	MasterBus network is configured as a ring network.	Ring networks are not allowed. Check the connections of the network (see section 3.3).
	T-connections in the MasterBus network.	Check if T-connections are made in the network. T-connections are not allowed (see section 3.3).
Touch screen does not react.	Keyboard Lock has been activated.	Press button long to unlock keyboard, see figure 10.
Functions are controlled without intention while touch screen is cleaned.	A touch screen reacts at every touch.	Press button long to lock keyboard, see figure 10. Clean touch screen with a soft cloth. Do NOT use acids or scourers! Press button long again to unlock keyboard.
One of the connected devices can not be found.	Settings error: maximum number of devices is 63.	If you want to monitor more than 63 devices, you need to have a second MasterView Easy panel.
	The display is in "Selection" mode with another device selected.	Change the setting to "All devices".
	Error in the wiring.	Check the MasterBus cables.
	Device not suitable for MasterBus or it is excluded in the "Excluded" mode.	Check whether the device is suitable for MasterBus. Maybe the MasterBus cable is connected to a non-MasterBus connector.
<i>MasterView Easy</i> is switched off after some time.	The <i>MasterView Easy</i> is set up to switch off automatically, when no button is touched for 1 day.	See section 6.2 for settings (Auto off).
The device name is not correct.	Device name has not yet been set.	Adjust device name, see section 6.2.

Failure	Possible cause	What to do
Wrong language is displayed.	Wrong setting of the language at the MasterView Easy.	See section 6.2 for adjustment of the language.
	Wrong setting of the language at one of the connected devices.	Each separate connected device can have its own language setting. See user's manual of the connected devices.
Wrong boat name is displayed.	Wrong setting of the yacht name at the MasterView Easy.	See section 6.2 for setting "Name yacht".
A set value shown in the display is not correct.	Value has not been set yet or it can not be set.	Go to Configuration and change the value using arrows. If the value is not adjustable, no arrows are shown.
The Favourites page does not pop up automatically.	You are in configuration and you want to check the Favourites page.	Click the X repeatedly to enter the device list. This is the MasterView Easy starting screen. It changes to your Favourites page automatically.
Your Favourites page does not show the right parameter	Selecting a device's monitoring group and item number, you chose another parameter than intended.	Check the user's manual of the device that features the selected monitoring parameter. NOTE: Start to count at 1 for group and item number!
You don't have the slightest idea where in the menu structure you have ended up.	You just discovered some unexpected screens.	Click the X repeatedly to enter the device list. This is the MasterView Easy starting screen. It changes to your Favourites page automatically.

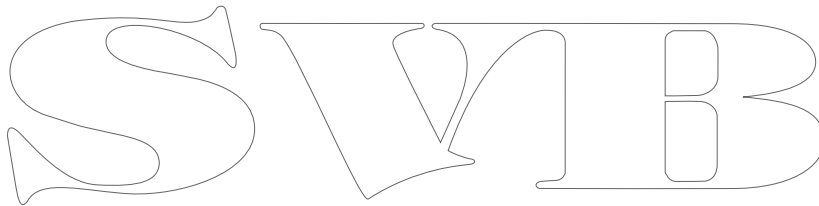

9 SPECIFICATIONS

9.1 TECHNICAL SPECIFICATIONS

Model:	MasterView Easy MkII
Article number:	77010305
Delivery includes:	Panel, outer casing, MasterBus Terminating device, MasterBus connection cable (6m/20ft), user's manual / screws / mounting sticker
Function of instrument:	Monitoring, configuration and switch control of devices that are connected to the MasterBus network
Manufacturer:	Mastervolt Amsterdam, the Netherlands
Readout:	By means of an LCD touch screen
Available languages:	English, Nederlands, Deutsch, Français, Castellano, Italiano, Norsk, Svenska, Suomi, Dansk.
Powering capabilities:	No, needs to be powered via the MasterBus (at least one of the connected devices should have powering capabilities)
MasterVision compatible:	No
Power consumption:	Off: 16 mW On: 160 mW (backlight off); 900mW (backlight on)
Dimensions:	See section 9.2
Required depth:	38 mm minimum
Weight:	230 g (0.50 lb)
Protection degree:	IP 21

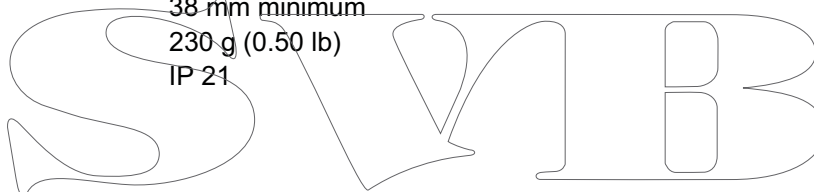

9.2 DIMENSIONS

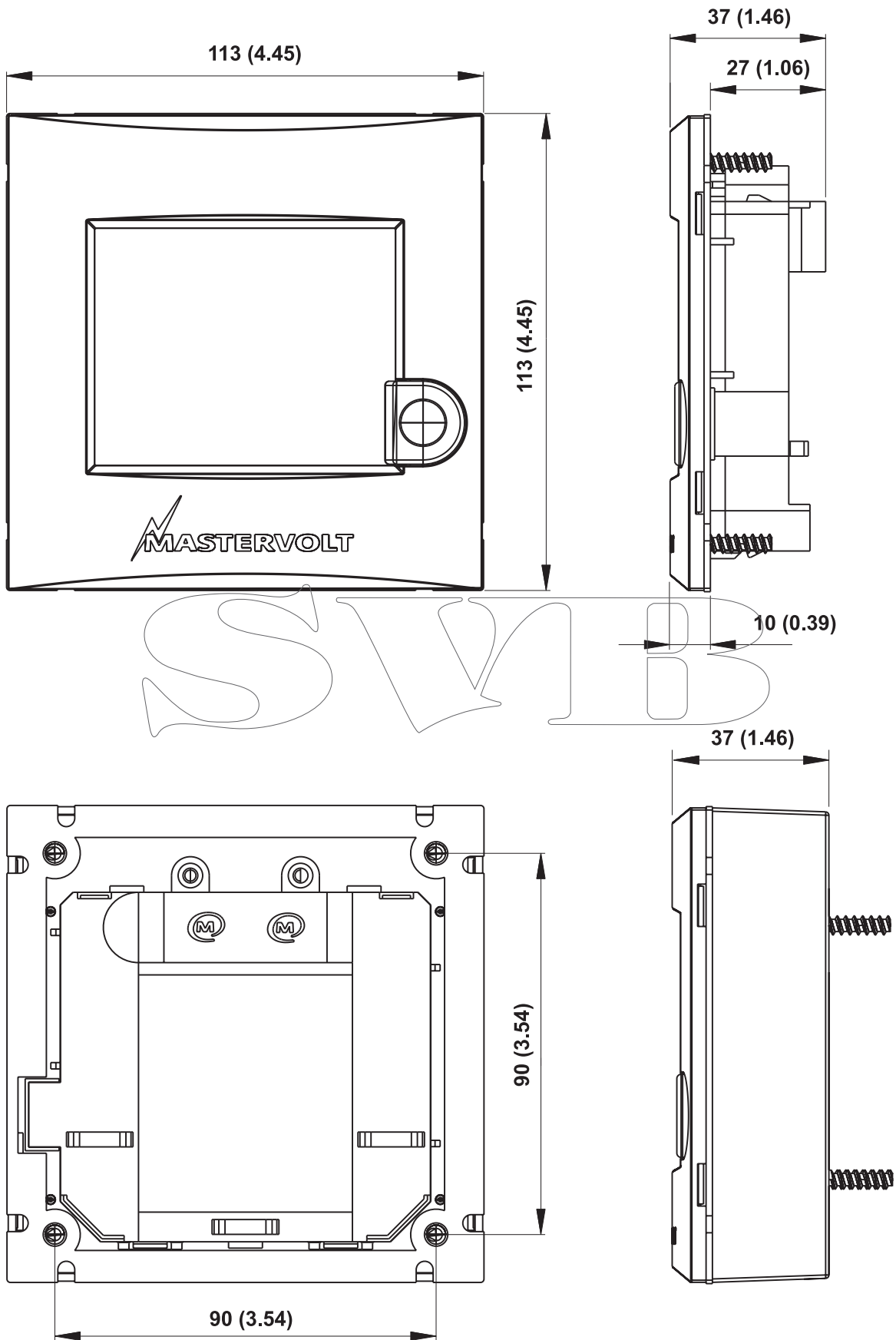

Fig. 22: Dimensions in mm (inch) of the panel without and with outer casing.

10 EC DECLARATION OF CONFORMITY

Manufacturer Mastervolt
Address Snijdersbergweg 93
1105 AN Amsterdam
The Netherlands



Herewith declares that:

Product:
77010305 MasterView Easy MkII

Is in conformity with the provision of the EC EMC directive 89/336/EEC and amendments 92/31/EEC, 93/68/EEC.
Low voltage directive: 2006/95/EC

The following harmonised standards have been applied:

Generic emission standard: EN 50081-1:1992
Generic immunity standard: EN 50082-1:1997

Amsterdam,



SVIB

P. F. Kenninck,
C.E.O. MASTERVOLT

SVIB



Snijdersbergweg 93, 1105 AN Amsterdam, The Netherlands

Tel : + 31-20-3422100

Fax : + 31-20-6971006

Email : info@mastervolt.com