

9 MagicEzy SECOND CHIPFIX

HOW TO APPLY

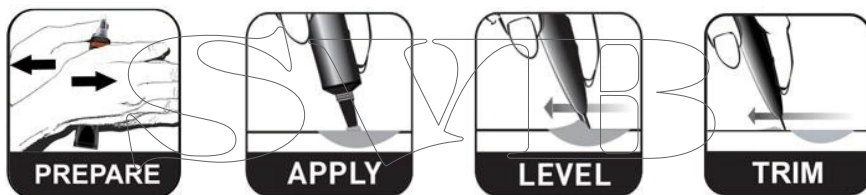

STEP 1 : PREPARE

- Not recommended for areas continually submerged in water
- Wash/scrub with soapy water into damage, then rinse with clean water. Allow to fully dry in sun or accelerate dry with a hairdryer.
- Rotate/shake the tube for 30 seconds for even consistency.

STEP 2 : APPLY

- For plastic or aluminum surfaces, apply a thin coat of MagicEzy MegaFusion Primer/Sealant and allow 2 hours to cure (at 70°F/20° C).
- APPLY and overfill the damage, whilst holding a tissue in your spare hand.

REPAIR SECRETS

Color match ?

Mix two or more colors on a clear plastic wrap. View new color when placed over the surface.

How do I apply on vertical surfaces ?

To prevent slump or for a FAST dry time, use a hairdryer for 3 minutes to form a skin.

STEP 3 : LEVEL

- LEVEL at 90°. A gentle touch is required (as if the 'LEVEL' is floating on air).

STEP 4 : TRIM

- Clean 'Level' with the tissue then TRIM smears around the repair using the level (not the repair itself). Repeat TRIM if necessary. Avoid excessive tampering.

How do I get a gloss finish ?

MagicEzy 9 Second Chip Fix dries matte. Add a thin top coat of MagicEzy Hairline Fix for gloss.

How do I apply in hot / cold weather?

In temperatures above 90°F (30°C) lay a damp towel over the area until hand temperature is reached. Below 60°F /15°C, set with hairdryer for 3 minutes.



NOTES

- DRYING time varies depending on temperature. FAST DRY using a hot hair dryer for 3 minutes + 30minutes cool down. NORMAL DRY 2 hours (at 70°F/20° C). It will harden overnight and achieve maximum strength and adhesion after 14 days. A second application of 9 Second Chip Fix may be required.
- DEEP DAMAGE Apply in ¼ inch (6mm) layers and allow to DRY for 2 hours at 70°F/20° C or 3 minutes using a hairdryer (plus 30mins cool down) then apply the next layer.



Zi du Capitou - 85 Avenue Louis Lépine - 83600 Fréjus - FRANCE
Tel: +33 (0)4 94 53 27 70 - Fax: +33 (0)4 94 53 27 62
Info@seaviewprogress.com - www.seaviewprogress.com